

# K-8

## 低圧広角タイプ スプレーノズル

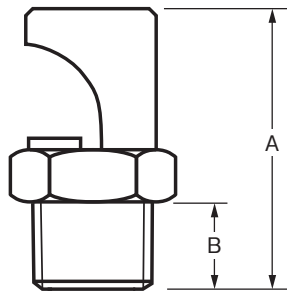

管径 in	寸法 mm		重量 g
	A	B	
1/8	25	8	14
1/4	32	10	25
3/8	35	11	46
1/2	42	14	84
3/4	55	17	140

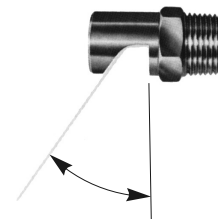
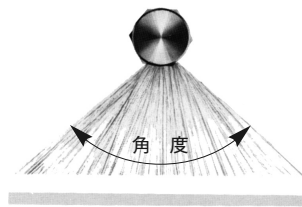

R $\frac{1}{8}$ =60°  
R $\frac{1}{4}$ 以上=70°

管径 in	吹出穴 mm	水 量 L/min / Spray 角 度										
		水圧 (MPa)	0.0196	0.029	0.049	0.069	0.098	0.147	0.196	0.245	0.294	0.392
		(kg/cm <sup>2</sup> )	0.2	0.3	0.5	0.7	1.0	1.5	2.0	2.5	3.0	4.0
1/8	1.0				0.48/80°	0.58/95°	0.68/95°	0.83/110°	0.95/120°	1.10	1.20	1.33
	1.2				0.63/80°	0.75/85°	0.90/100°	1.10/120°	1.28/130°	1.50	1.60	7.78
	1.6			0.80/85°	1.08/90°	1.25/95°	1.50/100°	1.80/120°	2.06/130°	2.25	2.38	2.60
	2.0	1.10/90°	1.28/95°	1.58/100°	1.90/110°	2.30/110°	2.80/120°	3.20/130°	3.60	3.90	4.30	
	2.5	1.60/90°	1.90/95°	2.45/110°	2.80/110°	3.35/120°	4.08/130°	4.70/130°	5.30	5.75	6.40	
1/4	2.0	1.10/90°	1.28/95°	1.58/100°	1.90/110°	2.30/120°	2.80/130°	3.20/130°	3.60	3.90	4.30	
	2.5	1.60/90°	1.90/95°	2.45/100°	2.80/110°	3.35/115°	4.08/120°	4.70/130°	5.30	5.75	6.40	
	3.2	2.00/110°	2.70/110°	3.80/120°	4.80/120°	5.80/130°	7.20/130°	8.30/140°	9.20	9.80	10.90	
	4.0	3.50/120°	4.80/120°	6.20/130°	7.60/130°	9.10/135°	11.00/140°	12.80/140°	14.30	15.80	18.00	
3/8	3.2	2.00/90°	2.70/100°	3.80/100°	4.80/100°	5.80/115°	7.20/120°	8.30/130°	9.20	9.80	10.90	
	4.0	3.50/95°	4.80/110°	6.20/110°	7.60/120°	9.10/130°	11.00/130°	12.80/140°	14.30	15.80	18.00	
	4.8	6.00/100°	7.70/120°	9.40/130°	11.40/150°	13.80/170°	16.50/170°	19.00/170°	21.20	23.30	26.90	
	5.5	7.80/95°	10.50/110°	12.60/120°	15.00/130°	18.00/140°	22.10/140°	25.50/140°	28.30	31.20	36.00	
1/2	5.6	8.10/100°	11.00/120°	13.00/130°	15.50/130°	18.40/135°	22.50/140°	26.00/140°	28.70	31.50	36.60	
	6.4	11.50/100°	13.90/110°	17.30/120°	20.60/130°	25.00/130°	31.10/140°	36.30/140°	40.00	43.60	50.20	
	7.5	16.00/120°	21.00/120°	25.50/130°	30.00/130°	35.90/130°	43.80/130°	50.80/135°	57.20	62.10	71.30	
3/4	9.0	24.00/110°	31.00/110°	38.00/120°	45.00/120°	54.00/125°	66.00/130°	76.00/130°	85.00	93.00	106.00	
	12.7	42.00/110°	53.00/110°	67.00/120°	79.00/120°	94.00/125°	115.00/130°	133.00/130°	147.00	160.00	185.00	

※記載の数値は代表値であり、保証値ではありません。